

Bird House

Let's Get Started!

Plan ahead before starting your BIRD HOUSE model, by sanding and painting all parts before gluing each piece. Apply glue to the shaded areas. For best results follow the simple instructions below to make your very own BIRD HOUSE model.

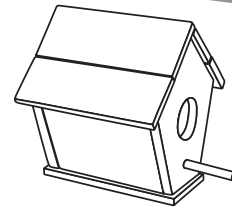

IN THIS KIT

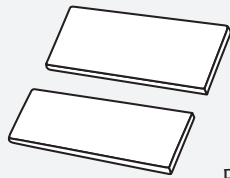

Roof Panels

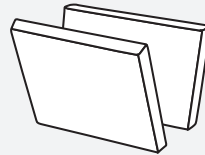
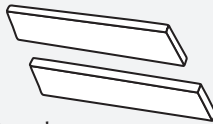

Side Panels

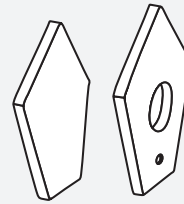

Face Panels



Base



Perch

1

Glue the face panels to the base as shown.

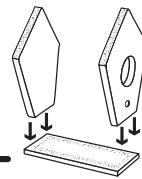

2

Glue the side panels to the front and rear face panels as shown.

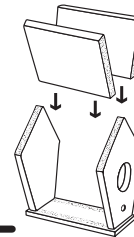

3

Glue perch to front face panel as shown.

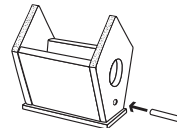

4

Apply glue along the edge of the front and rear panels. Begin to assemble the roof by applying the right side lower roof panel first. Add the upper right roof panel next. Add glue to the seam between the roof panels and press roof panels together to form a tight fit. PLEASE NOTE THAT ONE OF THE ROOF PANELS IS SLIGHTLY WIDER THAN THE OTHER THREE. THAT PANEL IS TO BE USED ON THE UPPER LEFT SIDE. DO NOT USE THIS PANEL IN THIS STEP.

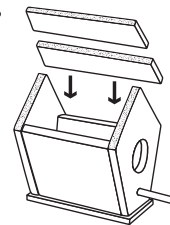

5

Repeat Step 4 for the left lower roof panel. The upper roof panel is slightly wider and will overlap to sit flush along the roof edge. Apply glue along the edge of the upper right roof panel. Apply upper right roof panel to the bird feeder.

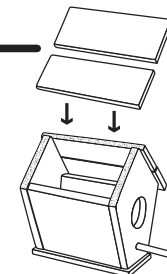

DECORATING TIPS:

Paint only the outside of your birdhouse. For outdoor use, it is recommended that a clear sealer be applied to the outside of the birdhouse. Apply the sealer after the paint has dried for at least 2 hours and allow the sealer to dry 24 hours before exposing to the outdoors.

Bird Feeder

Let's Get Started!

Plan ahead before starting your BIRD FEEDER model, by sanding and painting all parts before gluing each piece. Apply glue to the shaded areas. For best results follow the simple instructions below to make your very own BIRD FEEDER model.

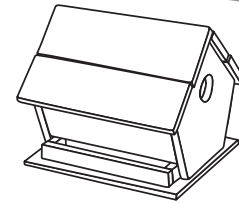

IN THIS KIT

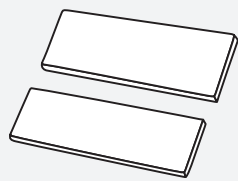

Roof Panels

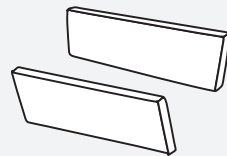
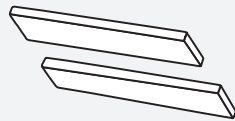

Feeder Panels

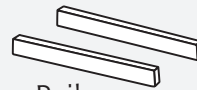

Rails

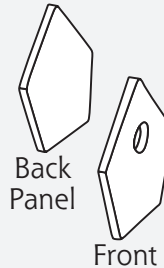

Back Panel

Front



Base



Blocks

1

Glue the blocks to the base as shown.

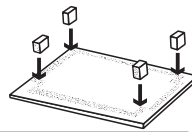

2

Glue the rails to the base as shown.

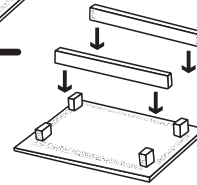

3

Glue front panel and back panel to base as shown.

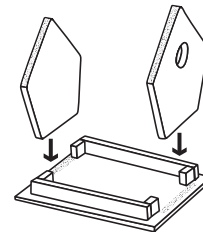

4

Slide the Side Panels between the Front and Rear Panels to ensure a good fit. The Side Panels will rest on the blocks. Be sure that there is a gap of at least 1/8" between the Side Panel and the Side Rail to allow the seed to come through. Once you are satisfied with the fit, remove the side panels, add glue to the ends and replace. Hold side rails in place for 2 – 3 minutes to ensure that the panels do not move during the remaining assembly.

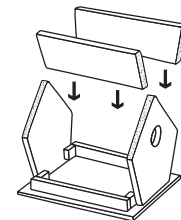

5

Apply glue along the edge of the front and rear panels. Begin to assemble the roof by applying the right side lower roof panel first. Add the upper right roof panel next. Add glue to the seam between the roof panels and press roof panels together to form a tight fit. PLEASE NOTE THAT ONE OF THE ROOF PANELS IS SLIGHTLY WIDER THAN THE OTHER THREE. THAT PANEL IS TO BE USED ON THE UPPER LEFT SIDE. DO NOT USE THIS PANEL IN THIS STEP.

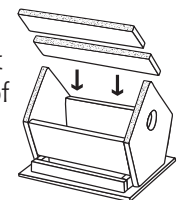

6

Repeat Step 5 for the left lower roof panel. The upper roof panel is slightly wider and will overlap to sit flush along the roof edge. Apply glue along the edge of the upper right roof panel. Apply upper right roof panel to the bird feeder.

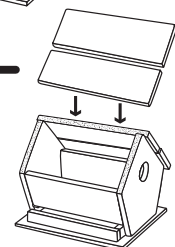

Jet

Let's Get Started!

Plan ahead before starting your JET model, by sanding and painting all parts before gluing each piece. Apply glue to the shaded areas. For best results follow the simple instructions below to make your very own JET model.

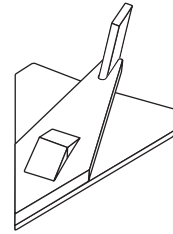

IN THIS KIT

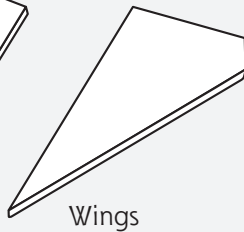

Wings

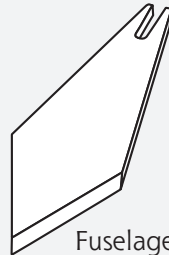

Fuselage



Tail Wing

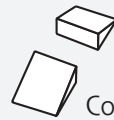

Cockpit

- 1** Run a bead of glue between the left and right delta wings. Press together.

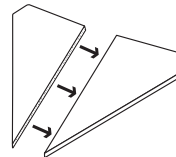

- 2** Add glue to the bottom of the fuselage and place onto delta wings as shown. Hold in place for 2-3 minutes or until glue has set. Wipe off any excess glue from around the fuselage or under the wings.

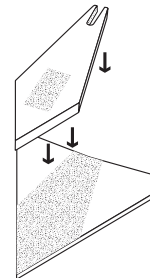

- 3** Add 2-3 drops of glue in the back section of the fuselage. Insert the tail wing into the slot. Hold in place until glue has set.

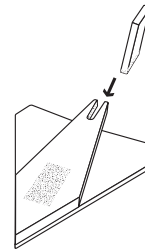

- 4** Glue cockpit onto top of fuselage as shown.

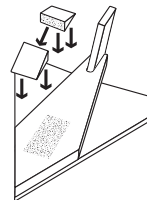

DECORATING TIPS:

Customize your jet by painting your name or favorite number on the plane. Draw designs such as lightning bolts, stars or add your favorite stickers to the plane. Now you are ready to play!

Race Car

Let's Get Started!

Plan ahead before starting your RACE CAR model by sanding and painting all parts before gluing each piece. Apply glue to the shaded areas. For best results follow the simple instructions below to make your very own RACE CAR model.

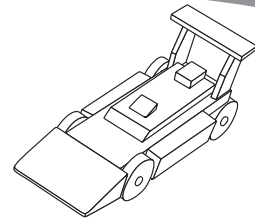

IN THIS KIT

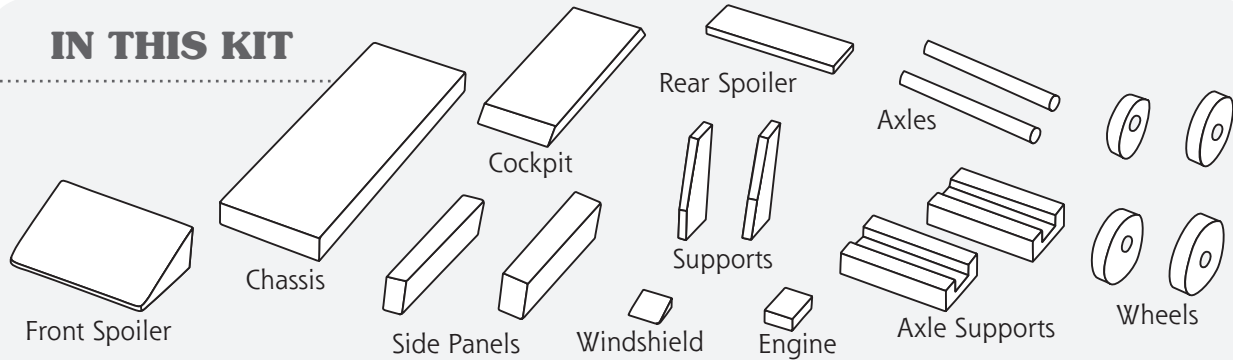

1

Glue wheels to axles. Lay axles into groove in axle supports. Be careful not to get glue onto the axle or the wheels will not spin. Apply glue to top of axle support being careful not to get glue on the axles.

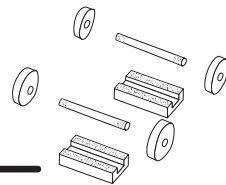

2

Position front and rear axle supports onto the bottom of the chassis being careful to allow enough space between the wheels to fit the side panels. Hold in place for 2-3 minutes or until glue has set. Make sure the wheels spin freely.

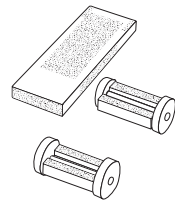

3

Glue front spoiler, side panels and cockpit to chassis as shown.

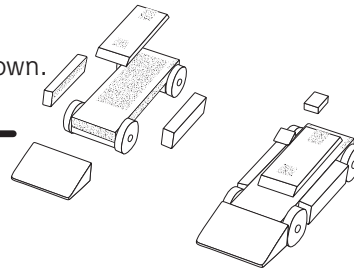

4

Glue windshield and engine onto chassis as shown.

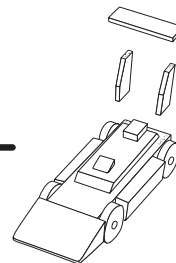

5

Glue spoiler and spoiler supports to chassis top as shown. Hold gently while glue sets.

6

Allow glue to dry for 30-45 minutes before playing with it.

DECORATING TIPS:

Customize your race car by painting racing stripes or your favorite number on the sides. Draw designs such as lightning bolts, stars or add your favorite stickers to the car. Now you are ready to play.