

Crystal Clear Décor

IN THIS KIT

- 3 crystal clear bottles
- 1 crystal clear case
- 6 paint pots
- 1 dimensional paint
- 1 paintbrush
- instruction sheet

Create sparkling room décor!

With this kit you can paint your crystal clear décor any way you like! Use the glass paints to create a beautiful, colorful design from your imagination.

about the PAINTS

Your kit comes with "glass paints". These paints are thin so that you can see through them when you paint them on your bottles. For darker colors, paint extra layers. Your kit also comes with a black dimensional paint. This is used to create the outlines and patterns that you will then fill in with the glass paints.

PAINTING TIP

With these paints you can create a stained glass window effect by making connecting patterns.

Design your bottle by drawing shapes on it.



Make a connecting pattern that covers the whole bottle to look like stained glass.



- 1 Choose a bottle or case to decorate, then create a design on it using the black dimensional paint. Let this dry completely.

NOTE: Each shape must be completely outlined with a solid line (no breaks or openings in the lines!). If you have a break in your line, when flowing paint is filling the shape the paint will run out of the opening into the shapes adjoining them.

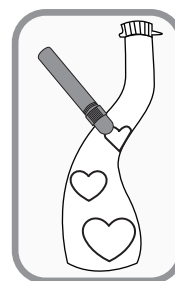

- 2 Fill in the design you created using the glass paints. Let dry. Add more layers if desired.

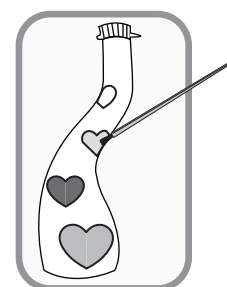

Now you have your own set of Crystal Clear Décor!

Crystal Charms

Create shimmering charms!

With this kit you can paint your charms any color you like and turn them into jewelry to make them your very own! Wear them yourself or share with your friends!

IN THIS KIT

6 crystal clear charms
6 paint pots
1 paintbrush
assorted crystal beads
ribbon
instruction sheet

about the PAINTS

Your kit comes with "glass paints". These paints are thin so that you can see through them when you paint them on your charms. For darker colors, paint extra layers.

- 1** Choose a charm and paint using the glass paints. Let dry. Add more layers if desired.

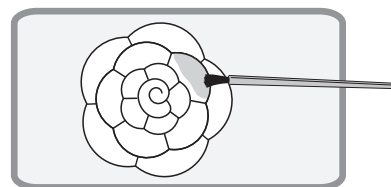

- 2** String your painted charm onto the ribbon. Select your beads then string or knot them (see below).

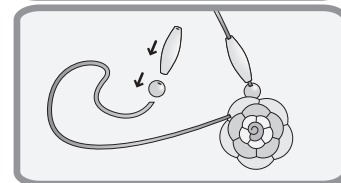

BEADING TIP

When stringing your beads you can string them next to your charm or you can separate the beads on sections of the ribbon.

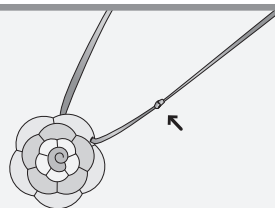

Make a knot on one side of the ribbon where you'd like your bead to sit.

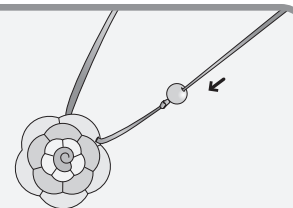

Choose a bead and slip it onto the ribbon.

- 3** Once you've designed your necklace or bracelet the way you like and strung the beads, tie and cut the cord. Your Crystal Charm jewelry is ready to wear!

Now you have your own set of Crystal Charms!

