

SCRUNCHIE MAKER

Fun to make! Fun to wear! Our unique Scrunchie Maker lets you design your own stylish hair accessories with funky fabrics, bright paint and sparkling gems. It comes with lots of fabrics so you can make some for yourself and share them with your friends.

Assembly:

Attach arms to the scrunchie maker base by sliding the arms into the side notches until they snap in. Make sure the angle of the slots in the arms align with the angle of the center peg (see picture).

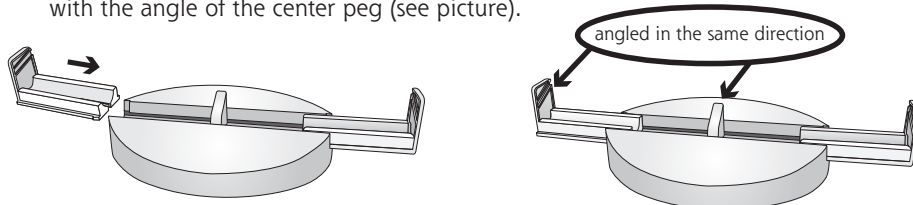

- 1** The working deck is made up of two panels that snap together: Panel A and Panel B. Using Panel B (see picture) begin by inserting one closure clasp of the elastic band through the notch. Draw the elastic band across the front and insert the other closure clasp through the notch on the opposite side.

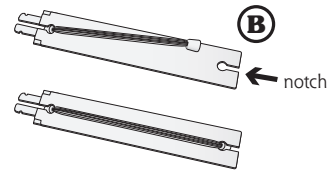

- 2** Insert Panel B into Panel A creating the working deck.

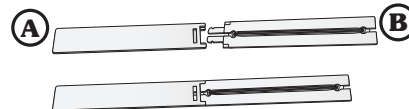

- 3** Choose a scrunchie sleeve and slide the sleeve onto the deck as shown.



- 4** Slide the deck into the slots in the arms of the Scrunchie Maker.

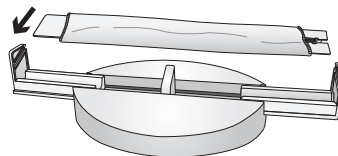

5 Decorate with paint. Let dry completely.

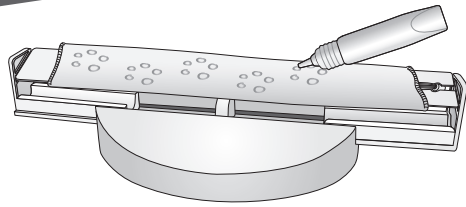

6 Decorate with gems by dabbing glue to the back of each gem and placing it on the scrunchie. Let dry completely.

Design Tip: Arrange the gems on the sleeve before gluing so that you can adjust the decorations.

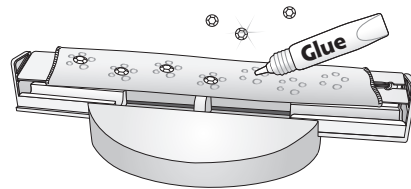

7 Once the scrunchie is finished, remove the panel from the Scrunchie Maker. Remove panel A. Scrunch the sleeve to Panel B so that the elastic band shows on both sides.

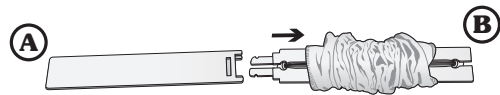

8 Pull the closure clasps off both sides of Panel B and close the clasp.



9 Slide Panel B out. Adjust the fabric so that the decorated side faces out.

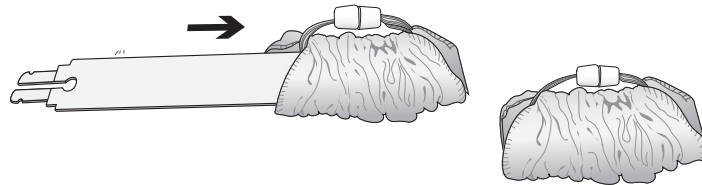

10 Tuck in one end of the fabric by folding into the scrunchie and pull over the other side so that the entire elastic band is covered. Dab fabric glue at the seam to secure in place.

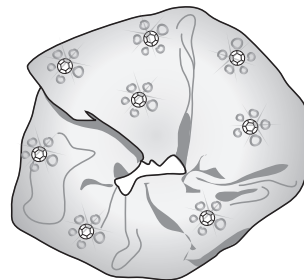

Now you have your own unique Scrunchie!